

MAKING ROOM

BUILDING COMMUNITY



Enlarge the place of your tent, stretch your tent curtains wide,
do not hold back; lengthen your cords, strengthen your stakes.
For you will spread out to the right and to the left...

Isaiah 54:2-3



LET'S GROW

Growth is a spiritual principle.

In the Garden of Eden, God gave Adam and Eve two very important commands. They were to tend the Garden and they were to multiply.

Since 1945, Rose Heights Church has been faithful to both tend and to multiply that which we have been entrusted. Through God's faithfulness, gifted leaders, and faithful members, we have grown into a multi-campus congregation that reaches both our community and the world with the Gospel of Jesus Christ.

That faithfulness leads us into a new phase of making room and building community. In Isaiah 54:2-3, the Lord told Israel to prepare for a season of growth. Using the illustration of a tent, God told them to stretch wide, strengthen their stakes, and prepare – for they *would* spread out.

After much prayer and planning, we believe God is calling us to a season of preparation. We will begin this work in April 2024.

Enclosed is an outline of our focus for the coming three years. With God's provision and your support, we will:

Stretch Ourselves
Strengthen Community
Spread His Love

I ask that you join us in prayer and partnership as we embark on this journey.

Let's Grow!

Allen Townsend
LEAD PASTOR
ROSE HEIGHTS CHURCH

*"Healthy things grow, and
growing things change, and
changing things change
things." – Christine Caine*

PRIORITY ONE: STRETCHING

Enlarge the place of your tent, stretch your tent curtains wide,
Isaiah 54:2

Our first priority will focus on renovating and updating our Tyler Campus and expanding our Lindale Campus.

TYLER CAMPUS

Beginning in the Spring/Summer of 2024, we will:

- Renovate the Sanctuary, adding new seating, new flooring, and new environmental elements
- Replace and refresh flooring and paint campus-wide
- Remodel and expand office spaces



PRIORITY ONE: STRETCHING

Enlarge the place of your tent, stretch your tent curtains wide,

Isaiah 54:2

KIDS FIRST

Our Kids First ministry spaces will be getting some much needed upgrades, remodels, and additions.

- New and redesigned Check-in areas
- Newly designed worship space
- New LED walls and technology
- New seating and furniture
- Upgraded playground facilities

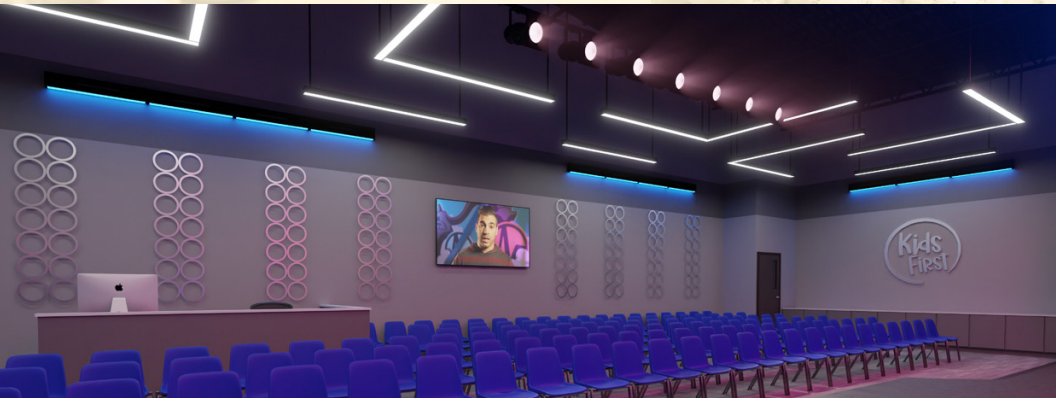

LINDALE CAMPUS

Beginning in the Spring/Summer of 2024, we will:

- Add an additional 6,000 sq ft of ministry space
- This addition will include:
 - A new Worship World area (Capacity: 130)
 - Four new classrooms for preschoolers
 - Two new multipurpose meeting rooms
 - Much needed restroom spaces
- With the addition, we will renovate and relocate some of our existing ministry spaces, including:
 - Relocating our Snack 'n Play and nursery rooms
 - Repurposing current Snack 'n Play to create a new Cafe and seating area

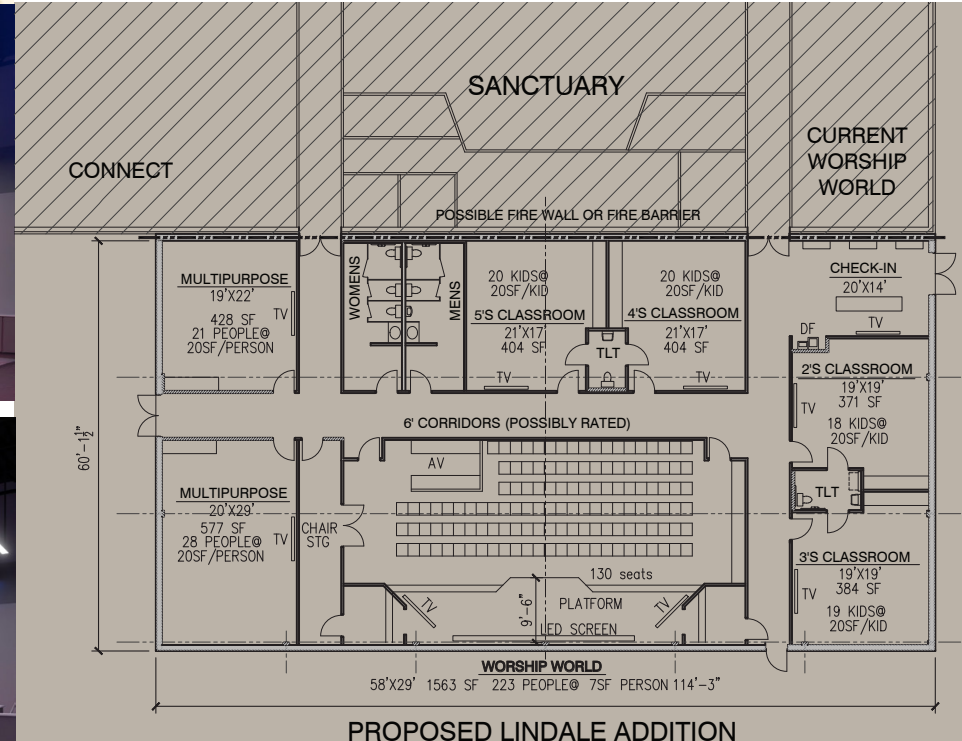

PRIORITY TWO: STRENGTHENING

...lengthen your cords, strengthen your stakes.

Isaiah 54:2



Our second priority is to strengthen community by expanding our gathering space in the foyer area.

EXPANDING FOYER

Additional space:

- Opening the foyer area and adding an additional 5,000 sq ft
- This will provide an area for connecting with guests and families

Cafe:

- We will add a new cafe and seating area in the foyer ▼

Multipurpose Area

- We will add a multipurpose area for conference registration, merchandise, meetings, and more

New Family Registration

- We will add two convenient and centralized family registration stations to allow simple and easy check-in for our first-time guests and families



PRIORITY THREE: SPREADING

For you will spread out to the right and to the left...

Isaiah 54:3

Our third priority is to spread Christ's love by preparing to launch a new Rose Heights campus.

Why a New Campus?

With the addition of our Lindale Campus, we have gained an incredible amount of insight about the potential of developing life-giving campuses in neighboring communities. In four short years, we have seen our Rose Heights Lindale enrollment increase by more than 500%.

Through strong community and relationships, we have been allowed to partner with local schools, host community ministry events, and invest in countless families within the greater Lindale area, all the while reaching record attendance at our Tyler Campus.

Where Next?

East TX is poised for accelerated growth and there is a clear need for new life-giving churches. We are researching an area that is within a 30-minute radius of our Tyler Campus, has seen profound population growth in recent years, and has strong projections for increased school enrollment and housing development.

Meanwhile, among our growth at Rose Heights, this region accounts for less than 4%. Similar to our experience with Lindale, one of the possible hindrances is that the travel time to the Tyler Campus is too great to develop community and worship with their neighbors.

Why Us?

Through our experience with our Lindale Campus, we believe a new Rose Heights campus is an opportunity to reach another community with the Rose Heights' DNA of love for God, love for one another, and the pursuit of excellence in all we do.

"Church campus expansion is the most effective way to both reach new people and release new leaders."

— Rich Birch

Preparing Now

As we prepare to reach another community, these funds will be utilized for:

- Identifying potential locations
- Securing facilities
- Building a launch team
- Beginning the process of launching our next campus

Regional Growth:

- Population increase: + 25%
- Housing units: + 23%
- School Enrollment: nearly + 300%
- Housing to increase by 2,800 homes (5-7 yrs)
- Meanwhile, this region is less than 4% of Rose Heights' growth in the last 4 years.

"Commuting longer distances can undermine mission, community, and discipleship." — Tim Keller



MAKING ROOM. BUILDING COMMUNITY.

Over the next three years, we are committed to **Making Room** and **Building Community**.

With You as Our Partner,

We will **stretch** ourselves to renovate our Tyler Campus and worship spaces, expand our Lindale Campus and Kids First Ministry areas, and add some much-needed office spaces.

We will **strengthen** our Tyler Campus community by enlarging our gathering areas, increasing opportunity for fellowship and relationship building.

And, we will **spread** Christ's love to a growing community through the addition of a new Rose Heights campus.

What's Next?

Pray.

At the center of our **Making Room, Building Community** campaign is prayer. Every step in this process must be bathed in prayer. If it is God's work, it is important that we depend on Him.

Give.

Take a step of faith and join our family of generous givers. Every gift, given in faith, moves the vision forward. Please complete the pledge card with your faith commitment. Gifts can be given to the **Making Room, Building Community** building fund.



CAMPAIGN OVERVIEW

Priority 1: Stretching

- **\$4.4M**
 - Tyler Campus Renovations
 - Lindale Campus Expansion
 - Office Addition

Priority 2: Strengthening

- **\$3M**
 - Tyler Campus Foyer Expansion

Priority 3: Spreading

- **\$2.5M**
 - Preparing to Launch a New Campus

Budgeting Your Gift Over the Next Three Years

WEEKLY	MONTHLY	QUARTERLY	ANNUALLY	3-YEAR TOTAL GIFTS
\$641	\$2,778	\$8,334	\$33,334	\$100,000
\$481	\$2,083	\$6,250	\$25,000	\$75,000
\$320	\$1,389	\$4,167	\$16,667	\$50,000
\$257	\$1,111	\$3,333	\$13,333	\$40,000
\$192	\$833	\$2,500	\$10,000	\$30,000
\$160	\$694	\$2,083	\$8,333	\$25,000
\$128	\$556	\$1,667	\$6,667	\$20,000
\$96	\$417	\$1,250	\$5,000	\$15,000
\$64	\$278	\$833	\$3,333	\$10,000
\$52	\$222	\$667	\$2,667	\$8,000
\$32	\$139	\$417	\$1,667	\$5,000



roseheights.org/grow